

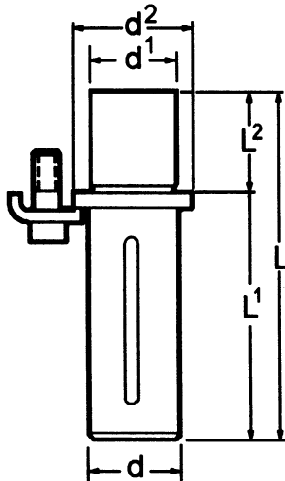

DEMOUNTABLE GUIDE POSTS

APD- unground *.015 grind stock on d' dimension

APG- finished ground



- Large savings in maintenance, repair costs and downtime

- A wide variety of sizes

- Long, trouble free production runs

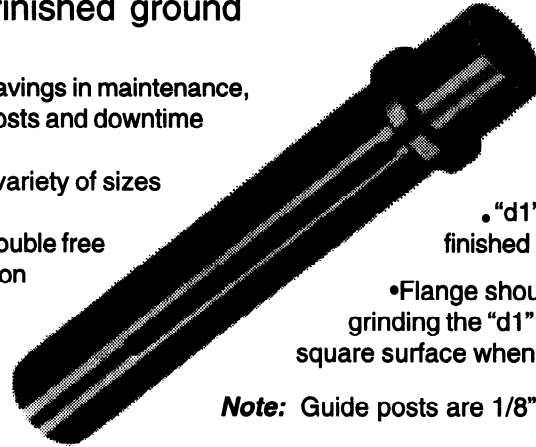

- Highest quality workmanship and materials

- "d1" dimension is finished ground.

- Flange should be ground flat when grinding the "d1" dimension to assure a square surface when seating the pin.

Note: Guide posts are 1/8" shorter than nominal.

Nom Post Dia d	Flange d ²	d ¹	L ²	L ¹	L	Catalog Number	Nom Post Dia d	Flange d ²	d ¹	L ²	L ¹	L	Catalog Number
1" (1.003)	1-5/16	1.0011 1.0006	1-3/16	2-1/2	3-3/4	APG0815	1-3/4" (1.753)	2-1/4	1.7511 1.7506	1-11/16	5-3/4	7-1/2	APG1430
				2-3/4	4	APG0816					6-1/4	8	APG1432
				3	4-1/4	APG0817					6-3/4	8-1/2	APG1434
				3-1/4	4-1/2	APG0818					7-1/4	9	APG1436
				3-1/2	4-3/4	APG0819					7-3/4	9-1/2	APG1438
				3-3/4	5	APG0820					8-1/4	10	APG1440
				4	5-1/4	APG0821					8-3/4	10-1/2	APG1442
				4-1/4	5-1/2	APG0822					9-1/4	11	APG1444
				4-1/2	5-3/4	APG0823					9-3/4	11-1/2	APG1446
				4-3/4	6	APG0824					10-1/4	12	APG1448
				5-1/4	6-1/2	APG0826					10-3/4	12-1/2	APG1450
				5-3/4	7	APG0828					11-1/4	13	APG1452
				6-1/4	7-1/2	APG0830					12-1/4	14	APG1456
				6-3/4	8	APG0832					13-1/4	15	APG1460
				7-1/4	8-1/2	APG0834					15-1/4	17	APG1468
				7-3/4	9	APG0836							
				1-1/4" (1.253)	1-9/16	1.2511 1.2506					1-3/16	3-1/4	4-1/2
3-1/2	4-3/4	APG1019	3-3/4				5-3/4	APG1623					
3-3/4	5	APG1020	4				6	APG1624					
4	5-1/4	APG1021	4-1/4				6-1/4	APG1625					
4-1/4	5-1/2	APG1022	4-1/2				6-1/2	APG1626					
4-1/2	5-3/4	APG1023	4-3/4				6-3/4	APG1627					
4-3/4	6	APG1024	5				7	APG1628					
5-1/4	6-1/2	APG1026	5-1/4				7-1/4	APG1629					
5-3/4	7	APG1028	5-1/2				7-1/2	APG1630					
6-1/4	7-1/2	APG1030	5-3/4				7-3/4	APG1631					
6-3/4	8	APG1032	6				8	APG1632					
7-1/4	8-1/2	APG1034	6-1/2				8-1/2	APG1634					
7-3/4	9	APG1036	7	9	APG1636								
8-3/4	10	APG1040	7-1/2	9-1/2	APG1638								
9-3/4	11	APG1044	8	10	APG1640								
10-3/4	12	APG1048	8-1/2	10-1/2	APG1642								
1-1/2" (1.503)	1-7/8	1.5011 1.5006	1-7/16	3	4-1/2	APG1218	2-1/2" (2.503)	3	2.5011 2.5006	1-15/16	9-1/2	11-1/2	APG1646
				3-1/4	4-3/4	APG1219					10	12	APG1648
				3-1/2	5	APG1220					10-1/2	12-1/2	APG1650
				3-3/4	5-1/4	APG1221					11	13	APG1652
				4	5-1/2	APG1222					12	14	APG1656
				4-1/4	5-3/4	APG1223					13	15	APG1660
				4-1/2	6	APG1224					14	16	APG1664
				5	6-1/2	APG1226					15	17	APG1668
				5-1/2	7	APG1228					16	18	APG1672
				6	7-1/2	APG1230					6	8	APG2032
				6-1/2	8	APG1232					6-1/2	8-1/2	APG2034
				7	8-1/2	APG1234					7	9	APG2036
				7-1/2	9	APG1236					8	10	APG2040
				8	9-1/2	APG1238					9	11	APG2044
8-1/2	10	APG1240	10	12	APG2048								
9	10-1/2	APG1242	11	13	APG2052								
9-1/2	11	APG1244	12	14	APG2056								
10	11-1/2	APG1246	15	17	APG2068								
10-1/2	12	APG1248	18	20	APG2080								
11	12-1/2	APG1250											
11-1/2	13	APG1252											
12-1/2	14	APG1256											
1-3/4" (1.753)	2-1/4	1.7511 1.7506	1-11/16	3-1/4	5	APG1420	3" (3.003)	3-1/2	3.0011 3.0006	2-7/16	5-1/2	8	APG2432
				3-1/2	5-1/4	APG1421					6	8-1/2	APG2434
				3-3/4	5-1/2	APG1422					6-1/2	9	APG2436
				4	5-3/4	APG1423					7-1/2	10	APG2440
				4-1/4	6	APG1424					8-1/2	11	APG2444
				4-1/2	6-1/4	APG1425					9-1/2	12	APG2448
				4-3/4	6-1/2	APG1426					10-1/2	13	APG2452
				5-1/4	7	APG1428					11-1/2	14	APG2456
			14-1/2	17	APG2468								
			17-1/2	20	APG2480								